

# AMERICAN ACADEMY OF PEDIATRIC DENTISTRY

MAY 23-26, 2019

HILTON - STEVENS MEETING CENTER - CHICAGO, ILLINOIS

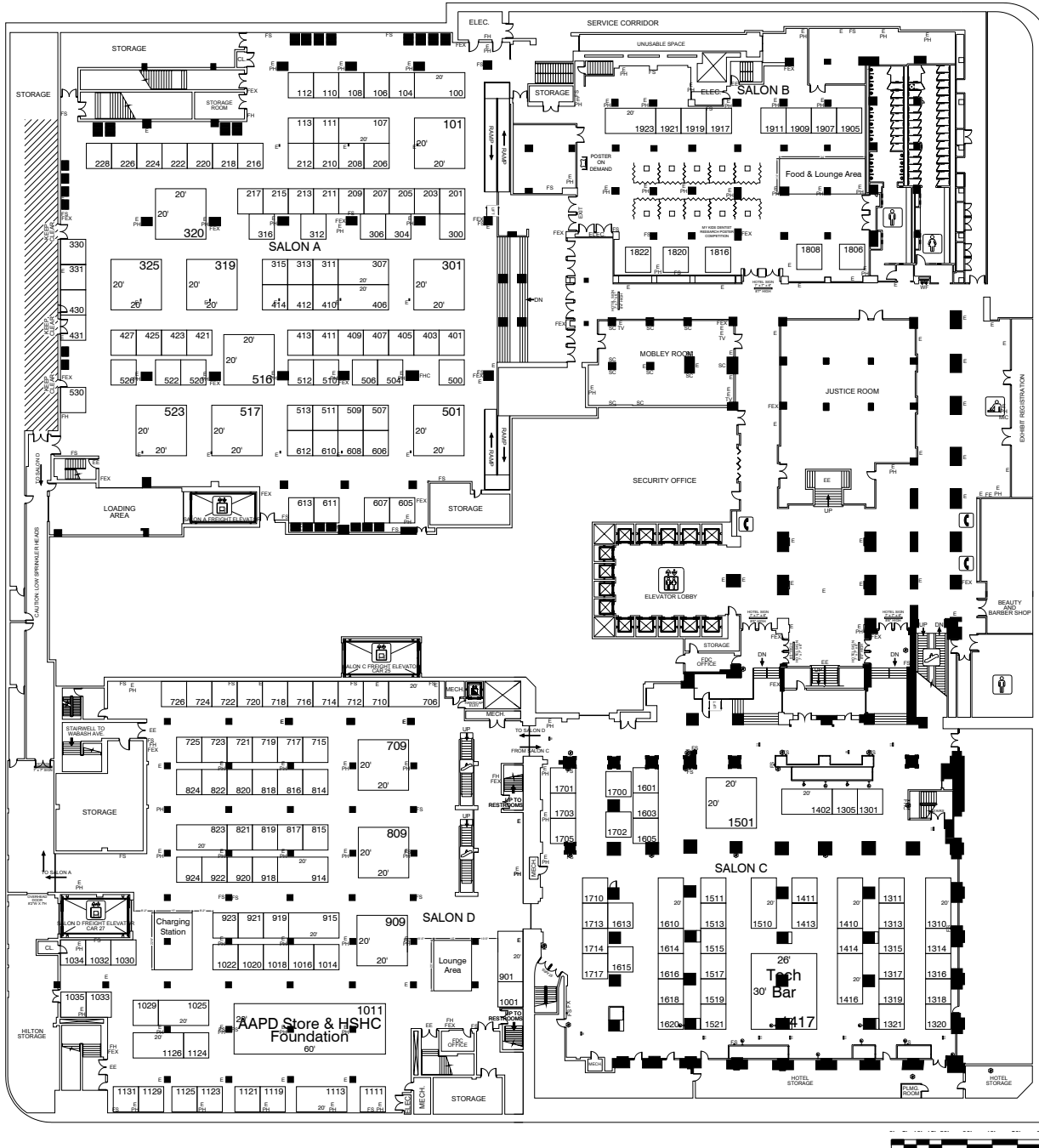

File Path: O:\NCRDC\Floor plans\Shows\18\05-May\Am Acadmy of Pediatric Dentistry - 452384\AAPD19 HILTON STEVENS MEETING CENTER SALONS A-D.dwg | Tab Name: FLOOR PLAN V1

## INDIVIDUAL SALON BOOTH COUNT

SALON A as of 05/16/2018

| Dimension      | Size | Qty       | SqFt          | Rented   | Available |
|----------------|------|-----------|---------------|----------|-----------|
| 10x10'         | 100  | 74        | 7,400         | 0        | 7         |
| 10x20'         | 200  | 4         | 800           | 0        | 0         |
| 20x20'         | 400  | 9         | 3,600         | 0        | 0         |
| <b>Totals:</b> |      | <b>87</b> | <b>11,800</b> | <b>0</b> | <b>8</b>  |

SALON B as of 05/16/2018

| Dimension      | Size | Qty       | SqFt         | Rented   | Available |
|----------------|------|-----------|--------------|----------|-----------|
| 10x10'         | 100  | 12        | 1,200        | 0        | 12        |
| 10x20'         | 200  | 1         | 200          | 0        | 1         |
| <b>Totals:</b> |      | <b>13</b> | <b>1,400</b> | <b>0</b> | <b>13</b> |

SALON C as of 05/16/2018

| Dimension      | Size | Qty       | SqFt         | Rented   | Available |
|----------------|------|-----------|--------------|----------|-----------|
| 10x10'         | 100  | 39        | 3,900        | 0        | 39        |
| 10x20'         | 200  | 6         | 1,200        | 0        | 6         |
| 20x20'         | 400  | 1         | 400          | 0        | 1         |
| 25x30'         | 750  | 1         | 750          | 1        | 0         |
| <b>Totals:</b> |      | <b>47</b> | <b>6,250</b> | <b>1</b> | <b>46</b> |

SALON D as of 05/16/2018

| Dimension      | Size  | Qty       | SqFt         | Rented   | Available |
|----------------|-------|-----------|--------------|----------|-----------|
| 10x10'         | 100   | 5         | 500          | 0        | 5         |
| 10x20'         | 200   | 6         | 1,200        | 0        | 6         |
| 20x20'         | 400   | 3         | 1,200        | 0        | 3         |
| 20x60'         | 1,200 | 1         | 1,200        | 1        | 0         |
| <b>Totals:</b> |       | <b>64</b> | <b>9,200</b> | <b>1</b> | <b>63</b> |

**REVISION**  
Date: 5/16/2018  
By: CARLOS D'APARICIO

## NET BOOTH COUNT

Inventory as of 05/16/2018

| Dimension      | Size  | Qty        | SqFt          | Rented   | Available  |
|----------------|-------|------------|---------------|----------|------------|
| 10x10'         | 100   | 177        | 17,700        | 0        | 177        |
| 10x20'         | 200   | 19         | 3,800         | 0        | 19         |
| 20x20'         | 400   | 13         | 5,200         | 0        | 13         |
| 20x30'         | 750   | 1          | 750           | 1        | 0          |
| 20x60'         | 1,200 | 1          | 1,200         | 1        | 0          |
| <b>Totals:</b> |       | <b>211</b> | <b>28,650</b> | <b>2</b> | <b>209</b> |

## BLDG. LEGEND:

- AV - AUDIO VIDEO OUTLET
  - AWD - AIR WATER DRAIN
  - E - GEN. ELECTRICAL OUTLET
  - E1 - ELECTRICAL 30A
  - E2 - ELECTRICAL 100A
  - E3 - ELECTRICAL 480A
  - ELEC - ACCESS POINT, POWER MAIN
  - EE - EMERGENCY EXIT, DO NOT BLOCK
  - FA - FIRE ALARM
  - WF - WATER FOUNTAIN
  - FEK - FIRE EXTINGUISHER
  - FHC - FIRE HOSE CABINET
  - ES - EXIT SIGN
  - FS - FIRE STROBE
  - STROBES ARE 6X6 AND 4" FROM FLOOR
  - MIC - MICROPHONE SERVICE
  - PH - TELEPHONE SERVICE
  - TV - TELEVISION SERVICE
- NOTE:  
ELECTRICAL SERVICE AVAILABLE FROM CEILING ON ALL HALLS.  
CEILING HEIGHTS VARIES THROUGHOUT THE HALLS.  
ALL SALON ARE CARPETED

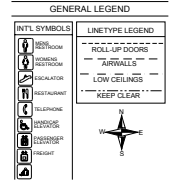

## DRAWING INFO

Passport Line Item Number:

**4447060**

Facility:  
**HILTON**  
Hall / Level:  
**STEVENS MEETING CENTER**  
City & State:  
**CHICAGO, ILLINOIS**  
Scale: **CUSTOM**  
Job #: **452384**  
AE: **SHANNON MCFALL**  
Prod. AE: **SHANNON MCFALL**  
Started: **5/16/2018**  
Started By: **CARLOS D'APARICIO**  
Prod. Branch: **CHICAGO**

## FREEMAN

**Disclaimer** - Every effort has been made to ensure the accuracy of all information contained on this floor plan. However, no warranties, either expressed or implied, are made with respect to this floor plan. If the location of building columns, utilities or other architectural components of the facility is a consideration in the construction or usage of an exhibit, it is the sole responsibility of the exhibitor to physically inspect the facility to verify all dimension and locations.  
© Copyright 2007, Freeman Co. All rights reserved.

**Confidential and Proprietary** - the information contained herein is the proprietary information of Freeman and by accessing the information, the recipient agrees to keep the information confidential and not disclose it to any third party without the prior consent of Freeman. Recipient also agrees to only use the information for its internal evaluation purposes and for no other purpose, without the prior consent of Freeman.